



Cabanne is an architectural structure that can be used singularly or in different combinations.

Structure: galvanized steel, matt varnished in avorio, grafite, mora, ruggine, sottobosco, oliva or foresta colour.

- with HEA base for the installation on not weight bearing surfaces
- with plates for the installation on weight bearing surfaces.

Both versions are available in two heights; the heights must be used when a finishing flooring is to be laid. A finishing flooring is always needed if Cabanne is used on not weight bearing surfaces.

Roof:

- aluminium, matt varnished in avorio, grafite, mora, ruggine, sottobosco, oliva or foresta colour
- aluminum frame with Sassafras wood lattices
- aluminum frame with Thuia fabric
- polyester net complete with a false ceiling in Thuia fabric

False ceiling: to be used with aluminium or wood lattices roofs, composed of two aluminium frames covered with Thuia fabric.

Side panels: fixed or moving

- aluminum frame with Sassafras wood lattices
- aluminum frame with Thuia fabric
- aluminum frame with transparent tempered extralight glass.

Notes:

Instead of side panels, Shade fabric curtains, sand color, can be used. The curtains are mounted onto the structure with a multithread AISI 316 stainless steel cable, tensioned with AISI 316 stainless steel screws.

The colour of the structure always matches the colour of the Thuia fabric.

CAD1A senza base montante basso, without base low uprights

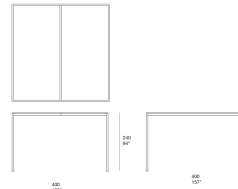

CAD1AH senza base montante alto, without base high uprights

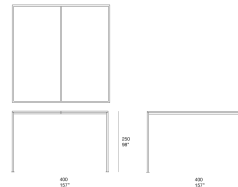

CAD1AB con base montante basso, with base low uprights

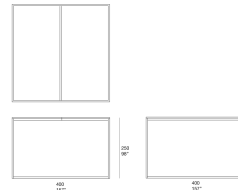

CAD1ABH con base montante alto, with base high uprights

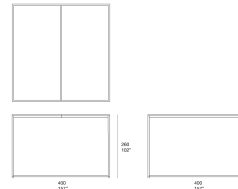

CAD1S tetto in alluminio / aluminium top

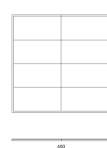

CAD1C tetto in tessuto / fabric top

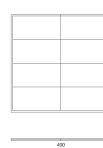

CAD1D tetto in listelli di legno / wood lattice top



CAD1E tetto in tessuto con sottotetto fabric top with false ceiling

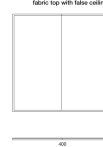

CAD1F sottotetto in tessuto fabric false ceiling



